

Dawlish Skip Hire, Shutterton Industrial Estate, Dawlish

Site Plan
OSGR SX 9677 7856



Existing
Licensed
Site



Now Part of
Existing Site



Rented Yard
Possible Site
Extension



Possible Site
Extension

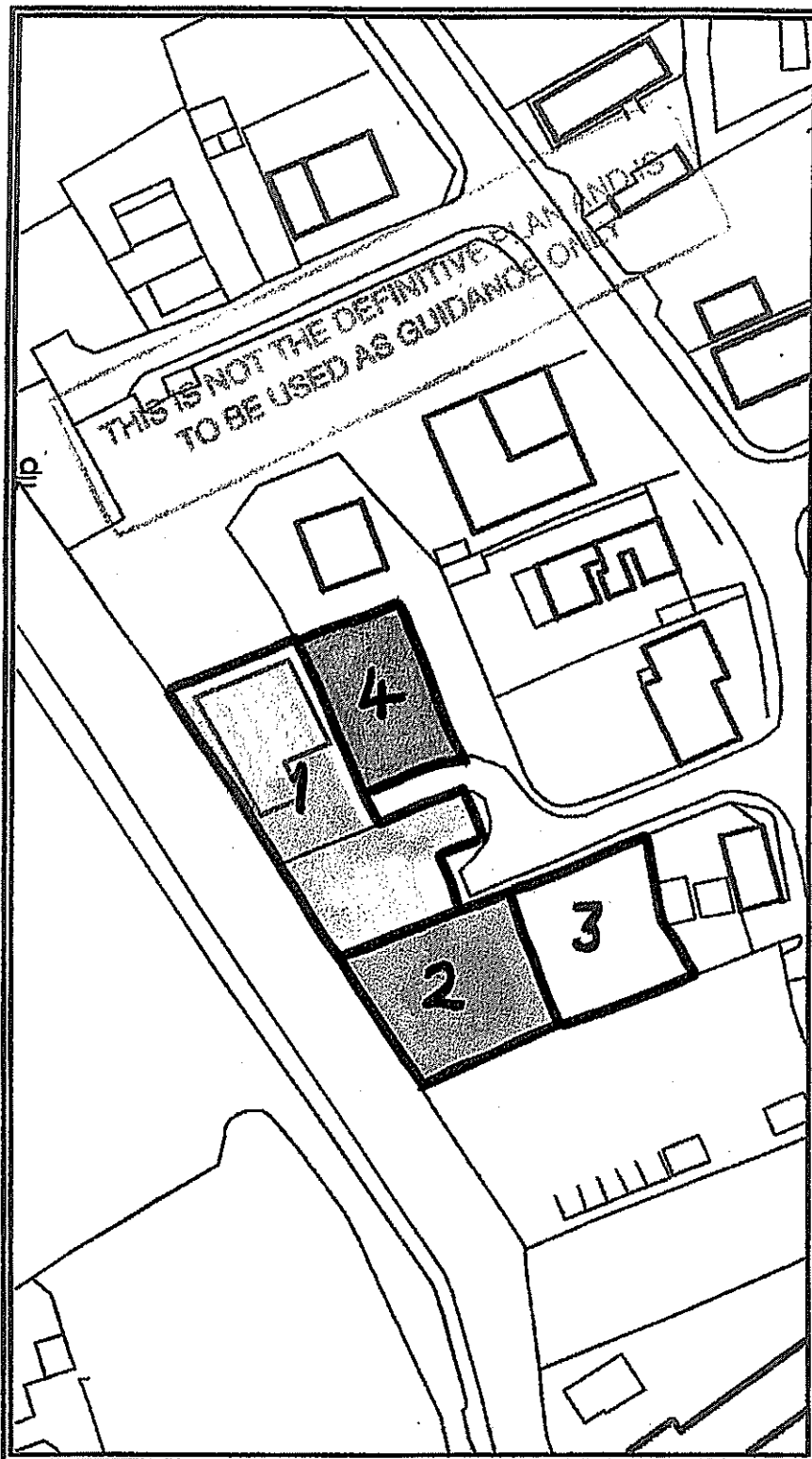

© Crown Copyright Licence No. LA 076362

OM3: Dawlish Skip Hire Ltd
Showing the existing site and extended site boundaries requested

?? DO NOT SCALE FROM THIS DRAWING ??

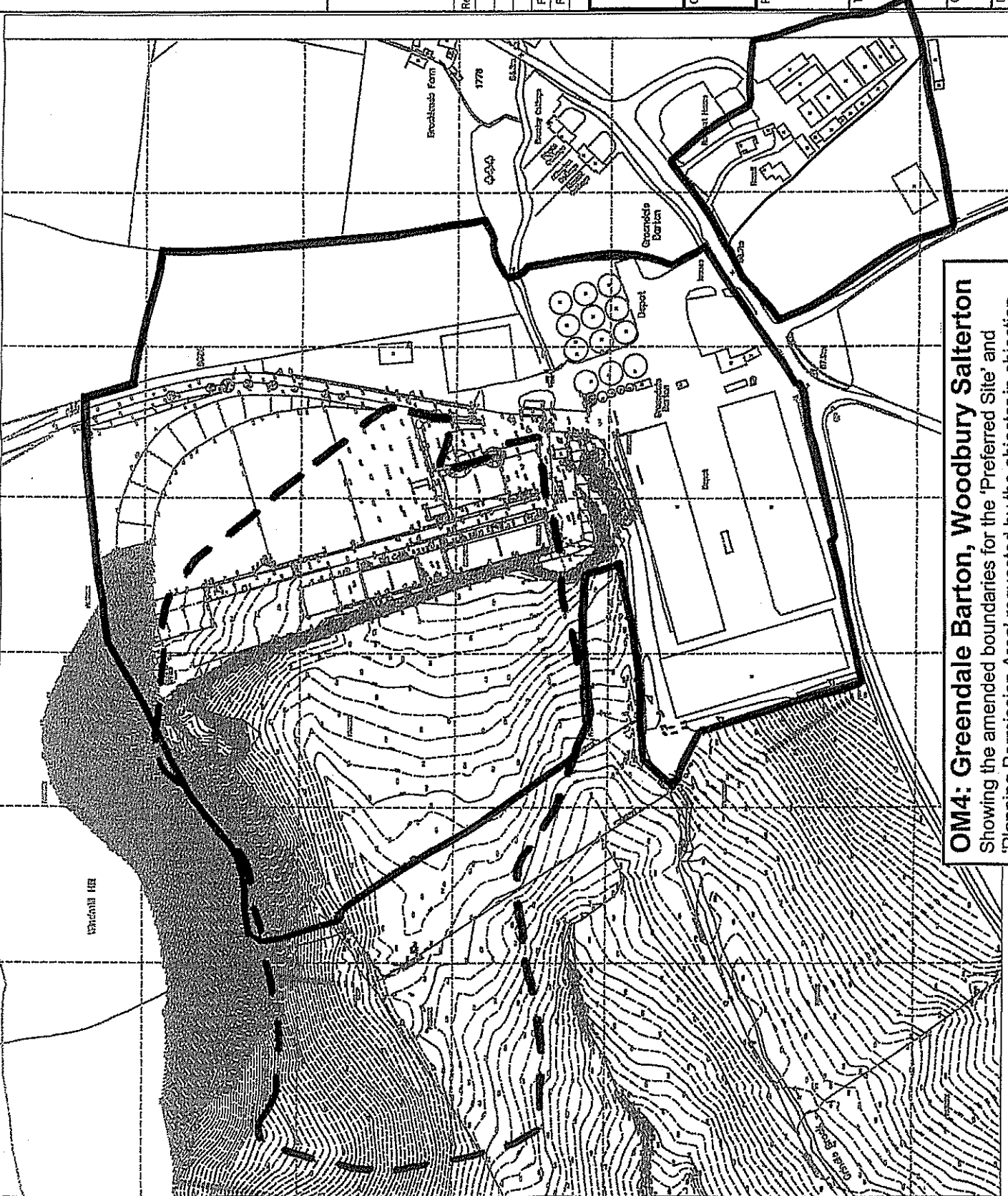

OM4: Greendale Barton, Woodbury Salterton
 Showing the amended boundaries for the 'Preferred Site' and
 'Planning Permission Area' requested by the objector in objection
 ref. 2139, 2140, 2142 and 2143

A3

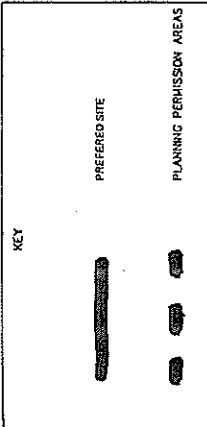

Rev	Modifications	By	Date	CHK'd	Auth

For Issue	For Client Approval	Purpose of Issue	Rev	Date	Authorised
P2	26/09/05	ARY			
P1	23/09/05	ARY			

ATKINS
 Design Environment & Engineering
 The Colson, The Colson
 Exeter, Devon
 Tel: +44 (0) 1392 325599
 Fax: +44 (0) 1392 325999

FWS CARTER AND SONS LTD

GREENDALE LANDFILL

**REPRESENTATIONS
 RE: INSET PLAN ED06
 DCC WLP REDEPOSIT VERSION**

Original Scale	Designed	Drawn	Checked	Authorised
1:2000	DATE: SEP 05	DATE: 28.09.05	DATE: 29.09.05	DATE: 29.09.05
	ATF	SPM	ATF	ATF
	DATE: SEP 05	DATE: 28.09.05	DATE: 29.09.05	DATE: 29.09.05

Drawing Number: 5030545-2502

Rev: P2

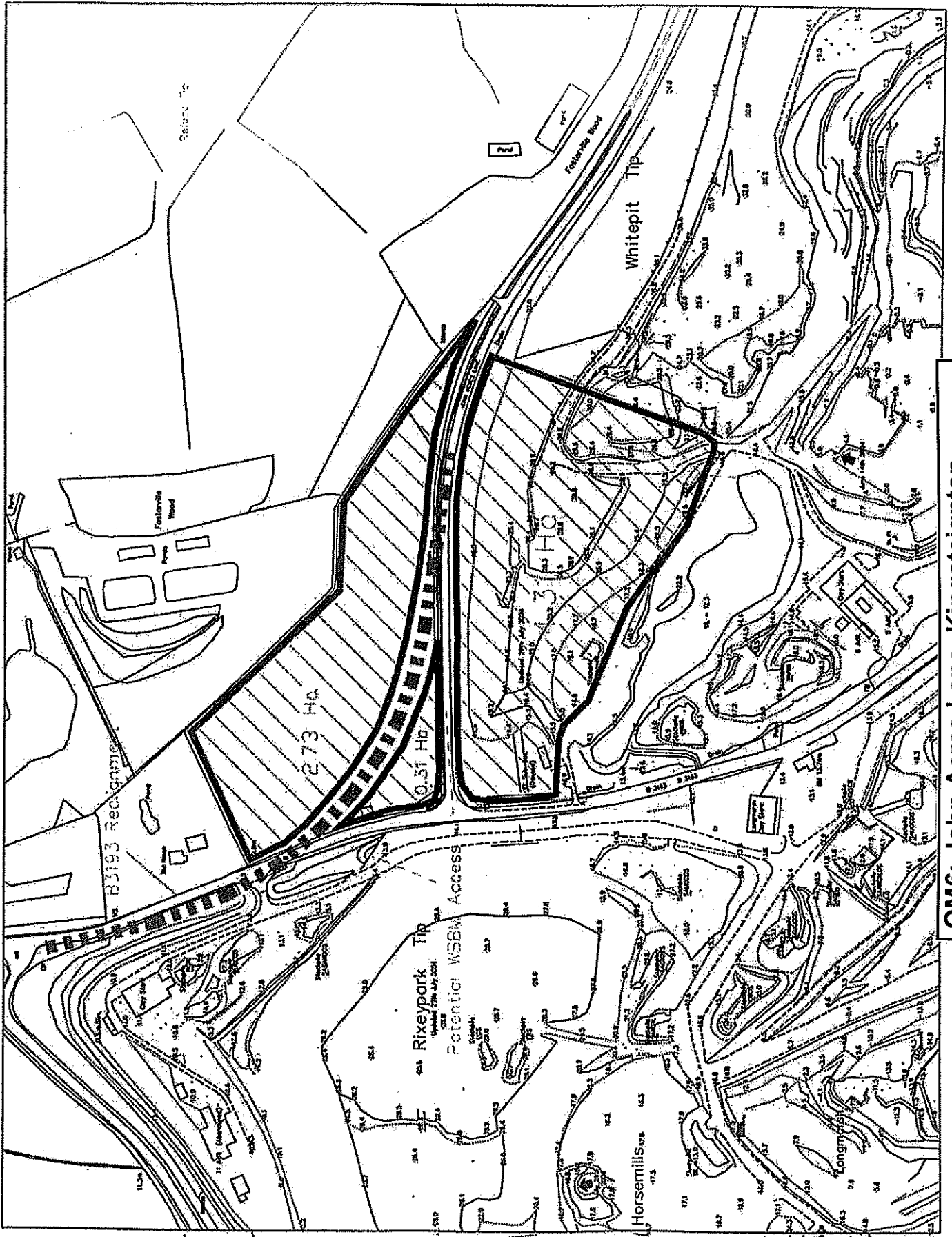

OM6: John Acres Lane, Kingsteignton
 Showing the boundaries of the site requested by the objector in
 objection ref. 2274 and 2277



OM7: Llangyfelach, Pembrokeshire
 Showing the general location of the site requested by the objector in
 objection ref. 2151 [no specific boundary was proposed by the
 objector]

Scale 1:10000

Based upon OS 1:10000 raster (1:11 km) © Crown copyright. All rights reserved. L1



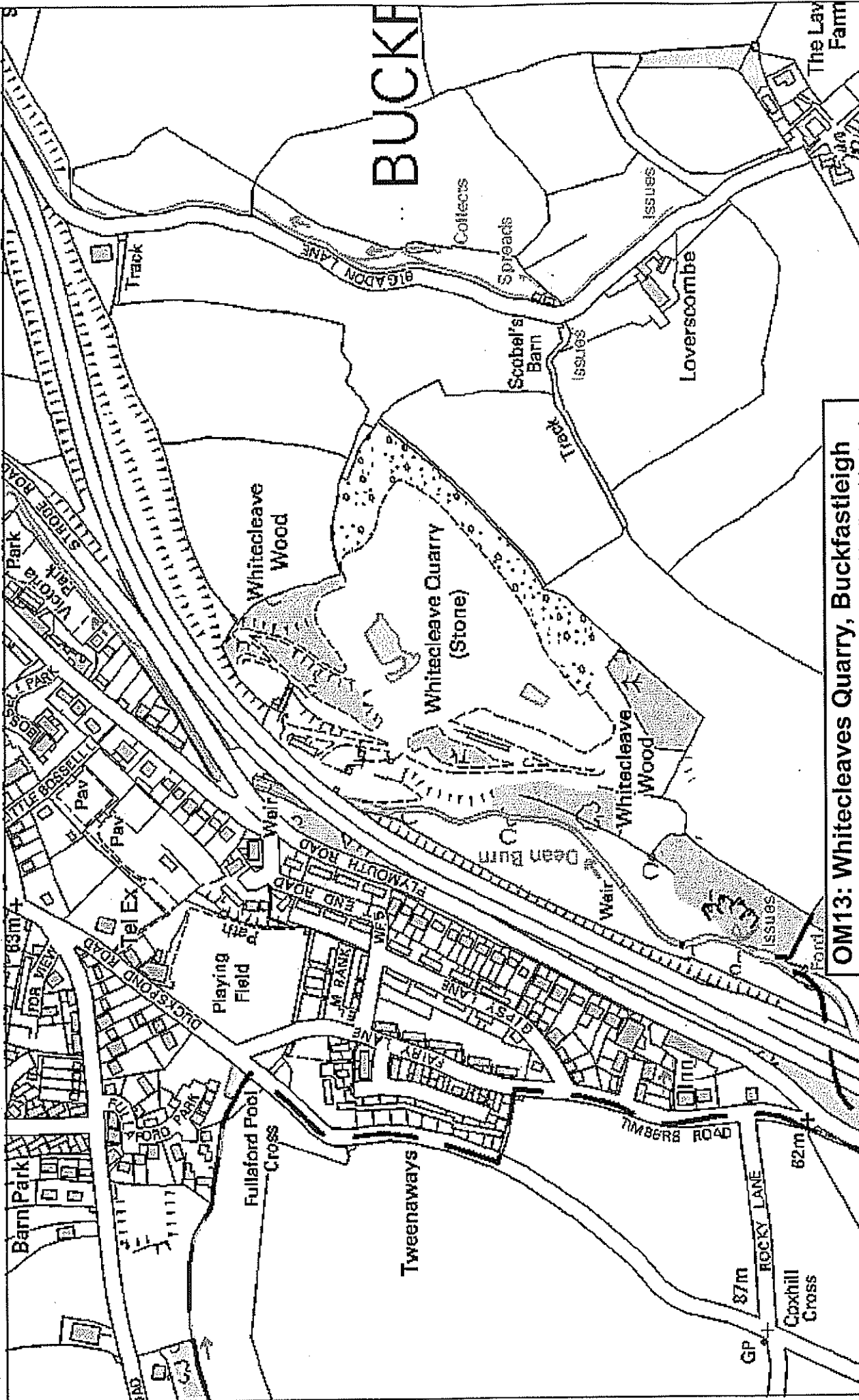

OM13: Whitecleaves Quarry, Buckfastleigh
 Showing the general location of the site requested by the objector in objection ref. 1655, 1715 and 2042 [no specific boundary was proposed by the objectors]

Scale 1:5000
 Based upon OS 1:100000 Ref: (11110) © Crown Copyright. All rights reserved. UTM

