



A380 South Devon Link Road (Kingskerswell Bypass)

Public Inquiry

Note by Devon County Council

Modifications to The Devon County Council (A380 South Devon Link Road (Kingskerswell Bypass) Classified Road) (Side Roads) Order 2008

and

The Devon County Council (A380 South Devon Link Road (Kingskerswell Bypass) Classified Road) (No. 2 Side Roads) Order 2009

1.0 Introduction

- 1.1 The Devon County Council asks the Inspector to recommend to the Secretary of State that the following modifications be made to The Devon County Council (A380 South Devon Link Road (Kingskerswell Bypass) Classified Road) (Side Roads) Order 2008, made on 12th September 2008 (**CD 1.2**) (The SRO).
- 1.2 In addition, The Devon County Council has resolved to make The Devon County Council (A380 South Devon Link Road (Kingskerswell Bypass) Classified Road) (No. 2 Side Roads) Order 2009. (The No. 2 SRO)

2.0 Reasons for Proposed Modifications to the The SRO

- 2.1 In the Proof of Evidence of Objector No. 10 (**OBJ/HWL(10)/P/1**), H.M. Land Registry Title Number DN 398174 is provided. Comparison of the title boundary line with The Devon County Council (A380 South Devon Link Road (Kingskerswell Bypass) Classified Road) (Side Roads) Order 2008 Plan Folio Site Plan 3 Inset (**CD 1.2**), (shown in DCC/REB/1, Appendix 2) shows that an area of land shown as 'Highway to be Improved' adjacent to the Barn Owl is not highway and should be removed from the SRO.
- 2.2 In addition, on The Devon County Council (A380 South Devon Link Road (Kingskerswell Bypass) Classified Road) (Side Roads) Order 2008 Plan Folio Site Plan 1 (**CD 1.2**), the southern New Highway Boundary line for New Highway labelled 'A' was omitted from the Site Plan. The New Highway Boundary line is coincident with the southern existing highway boundary line shown on Site Plan 1 Inset A for the Highway to be Stopped Up.

3.0 Modification to The SRO Site Plans

- 3.1 Document **DCC/INQ/4/1** is attached showing a revised Site Plan 1 (Drawing No. HEX43444A/SKC/446A).
- 3.2 Document **DCC/INQ/4/2** is attached showing a revised Site Plan 3 Inset (Drawing No. HEX43444A/SKC/450A).

4.0 Making of The No. 2 Side Roads Order

- 4.1 The Devon County Council made The Devon County Council (A380 South Devon Link Road (Kingskerswell Bypass) Classified Road) (No. 2 Side Roads) Order 2009 on 6th July 2009.
- 4.2 The Order will be advertised on 15th July 2009; the objection period will end on 1st September 2009.

5.0 Details of the No. 2 Side Roads Order

- 5.1 In summary, the No. 2 Side Roads Order provides for:
1. re-routing of footpath 45 through Sainsbury's;
 2. an emergency pedestrian access for Network Rail;
 3. a new private access to fields to the east of the C162 Old Newton Road.
 4. access to the exchange land from Churchway Lane.

6.0 Modifications to The SRO consequent on The No. 2 SRO

- 6.1 As a consequence of the No. 2 SRO, further modifications will be required to The SRO, as follows:
1. In Schedule 2 under Highways to be Stopped Up: Deletion of “Footpath No. 45.....Sainsbury’s Store.”
 2. In Schedule 2 under Reference Letters of New Highways: Deletion of “A Footpath”.
 3. On Site Plan 2 Inset: Deletion of New Highway ‘A’ and associated stipple mark.

SITE PLAN 1

DCC/INQ/4/1

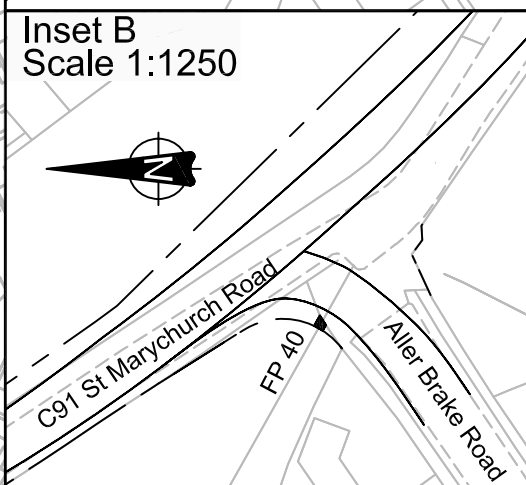
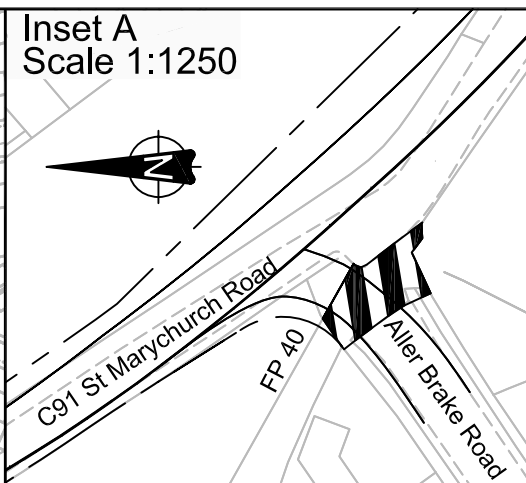
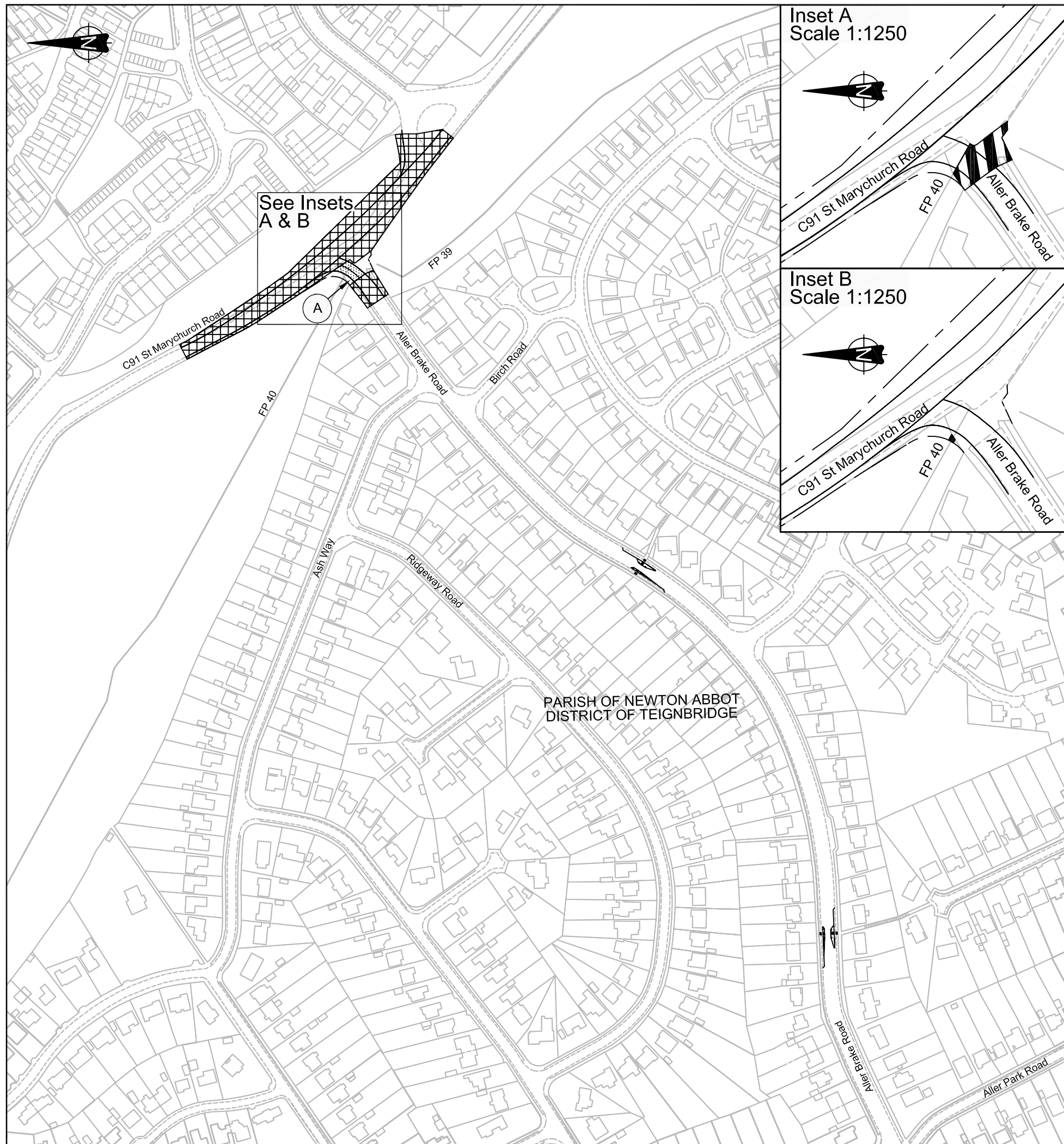

Drawing No. HEX 43444A/SKC/446A

Edward Chorlton
Director of Environment, Economy and Culture



This map is reproduced from the Ordnance Survey material with the permission of Ordnance Survey on behalf of the Controller of Her Majesty's Stationery Office © Crown Copyright. Unauthorised reproduction infringes Crown Copyright and may lead to prosecution or civil proceedings. Devon County Council Licence No. 100019783 2008.

EXTRACT FROM OS SHEETS
SX8769, SX8770, SX8869, SX8870

SCALE 1:2500

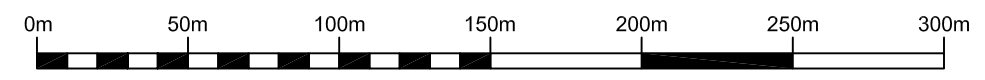

THE DEVON COUNTY COUNCIL (A380 SOUTH DEVON LINK ROAD (KINGSKERSWELL BYPASS) CLASSIFIED ROAD) (SIDE ROADS) ORDER 2008

St Marychurch Road, Aller Brake Road,
Footpath No. 40 and other alterations

THE EXTENT OF THIS INSET PLAN IS ALSO THE EXTENT OF THE PLAN "SITE PLAN 3"

Drawing No. HEX 43444A/SKC/450A

Edward Chorlton
Director of Environment, Economy and Culture



This map is reproduced from the Ordnance Survey material with the permission of Ordnance Survey on behalf of the Controller of Her Majesty's Stationery Office © Crown Copyright. Unauthorised reproduction infringes Crown Copyright and may lead to prosecution or civil proceedings. Devon County Council Licence No. 100019783 2008.

EXTRACT FROM OS SHEETS
SX8767, SX8768, SX8769

SCALE 1:2500 (Unless otherwise shown)

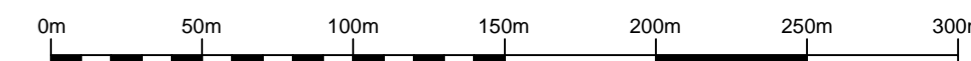

THE DEVON COUNTY COUNCIL (A380 SOUTH DEVON LINK ROAD (KINGSKERSWELL BYPASS) CLASSIFIED ROAD) (SIDE ROADS) ORDER 2008

Aller Road
and other alterations

